

S5-50/90, S6-65/66/70/75/80/90, 6S-800/1000/1200 TD/TO  
(Volvo ZTO 1006), 6AS 800/1000TO, 6S1005TO / 6.75 - 0.78

Frontal - Neumático (1:1)  
Rear - Pneumatic



## Descripción Description

Toma de fuerza directa, relación interna 1:1 para montar bombas ISO 4 taladros. Accionamiento neumático, montaje sobre el registro frontal de 4 taladros de la caja de cambios. Indicador de funcionamiento opcional.

Power Take-off direct, internal ratio 1:1 to connect Iso 4 bolts pumps. Pneumatic shifting, mounting on rear 4 bolts-window of the Gearbox. Optional: Passing contact switch or pressure switch

### Datos Principales Main Data

Par nominal Torque (Nm)		800
Potencia (1000 r.p.m.) Power (HP) 1000 r.p.m		114 C.V // 85 kW
Lado de montaje Mounting position		Posterior Rear
Sentido de giro de la bomba Pump rotation		Izquierdo Anti ClockWise
Peso Weight (Kg)		2,4
Relación motor - Toma de Fuerza Engine to PTO ratio	ANEXO ATTACHMENT	

### Códigos y Combinaciones Part Numbers and Combinations

Tipos de salida Output types		Plato Flange	Bomba Pump (DIN 5462)
Accionamiento neumático Pneumatic shifting		1015K02	1015K03

S5-50/90, S6-65/66/70/75/80/90, 6S-800/1000/1005/1200 TD/  
TO (Volvo ZTO 1006), 6AS 800/1000TO, 6S1005TO / 6.75 - 0.78

Frontal - Neumático  
Rear - Pneumatic

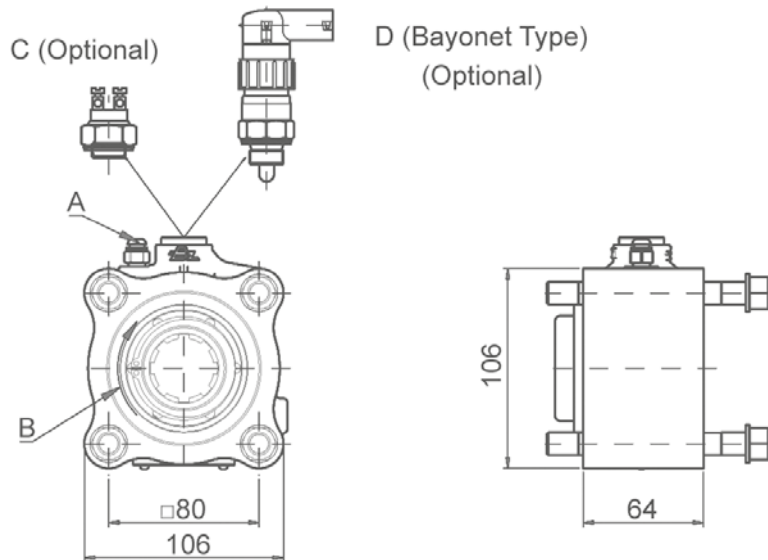

Notas Notes

A	Toma de aire, rosca 1/8" GAS	A	Air connection, thread 1/8" BSP
B	Sentido de giro	B	Rotation
C	Interruptor neumático. (100070018)	C	Pressure switch. P/N 100070018
D	Interruptor de contacto. (9024999)	D	Passing contact switch. P/N 9024999

Tipos de Salida Output Types

Adaptador Plato / Flange Adapter

SAE:	1100	7015504
	1300	
	1400	
DIN:	90	7015804
	100	7015704

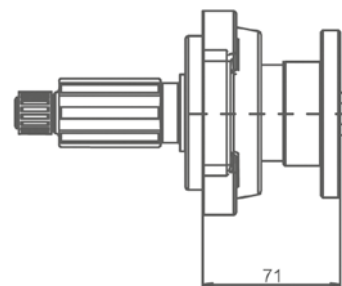

S5-50/90, S6-65/66/70/75/80/90, 6S-800/1000/1200 TD/TO  
(Volvo ZTO 1006), 6AS 800/1000TO, 6S1005TO / 6.75 - 0.78

Frontal - Neumático

Rear - Pneumatic

	CAJA	GEARBOX	RELACIÓN	RATIO
S5-50		/ 5.30		1: 0,653
		/ 5.50		1: 0.615
		/ 6.20		1: 0,545
		/ 6.61		1: 0,510
		/ 6.61 + GV80 / 5.30	Larga High Normal	1: 0,637 1: 0,510
		/ 8.02		1: 0,422
		/ 8.02 + GV80 / 6.20	Larga High Normal	1: 0,545 1: 0,421
S5-90GP		/ GPA		1: 0,890
S6-65		/ 6.37		1: 0,650
		/ 6.70		1: 0,620
		/7.0 + GV70 / 7.67	Larga High Normal	1: 0,456 1: 0,365
		/ 7.40		1: 0,562
		/ 7.52		1: 0,555
		/ 9.00		1: 0,462
		7.97 + GV80 / 6.70	Larga High Normal	1: 0,620 1: 0,525
		/ 9.00 + GV80 / 6.70	Larga High Normal	1: 0,620 1: 0,462
		/ 9.00 + GV80 / 7.52	Larga High Normal	1: 0,554 1: 0,462
	S6-66		/ 7.36-1.0	
		/ 9.06-1.0		1: 0,416
S6-70		/ 6.8		1: 0,514
		/ 6.8+GV70 / 5.71	Larga High Normal	1: 0,612 1: 0,514
		/ 7.36		1: 0,478
		/ 7.92		1: 0,441
		/ 9.03		1: 0,387
		/ 9.59		1: 0,365
S6-75		/ 6.70+GV80 / 7.52	Larga High Normal	1: 0,620 1: 0,554
	S6-80	/ 5.03		1: 0,780
		/ 5.66		1: 0,740

	CAJA	GEARBOX	RELACIÓN	RATIO
S6-80		/5.66 + GV80 / 7.52	Larga High Normal	1: 0,738 1: 0,556
		/ 6.10		1: 0,688
		/ 6.70		1: 0,620
		/ 6.7 + GV80 / 5.30	Larga High Normal	1: 0,787 1: 0,620
		/ 6.90		1: 0,515
		/ 7.35	Larga High	1: 0,552
		/ 7.41		1: 0,563
		/ 7.53		1: 0,555
		/ 7.67		1: 0,540
		/ 7.67 + GV80 / 6.70	Larga High Normal	1: 0,622 1: 0,543
		/ 7.90		1: 0,525
		/ 9.00		1: 0,460
		/ 9.00 + GV80 / 5.30	Larga High Normal	1: 0,787 1: 0,462
		/ 9.00 + GV80 / 7.48	Larga High Normal	1: 0,562 1: 0,462
		/9.00 + GV80 / 7.52	Larga High Normal	1: 0,554 1: 0,462
S6-90		/ 5.67		1: 0,750
		/ 5.74		1: 0,740
		/ 6.37		1: 0,740
		/ 6.98		1: 0,612
		/ 7.03		1: 0,603
		/ 7.03 + GV90 / 5.67	Larga High Normal	1: 0,750 1: 0,603
		/ 7.03 + GV90 / 5.74	Larga High Normal	1: 0,735 1: 0,600
		/ 7.40		1: 0,575
		/ 9.01		1: 0,470
		/ 9.01 + GV90 / 7.40		1: 0,573
6S800TO / 6.58 - 0.78 (Volvo ZTO 1006)				1: 0,471
6AS800TO / 6.58 - 0.78				1: 0,530
6AS1000TO / 6.75 - 0.78				1: 0,530
6S1000/1005 TO / 6.75 - 0.78				1: 0,530
6S1200TD / 7.72 - 1.00				1: 0,540
6S1200TO / 6.75 - 0.83				1: 0,620